

KEY

- Suburban Estates subsidized fencing, 1.8m high on boundary
- Corner section fencing, Suburban Estates requires a 1.0m setback from the road boundary as per land covenants
Please see Christchurch City Council requirements for any height restrictions
- Road frontage fencing, Suburban Estates requires a 1.0m setback from the road boundary as per land covenants
Please see Christchurch City Council requirements for any height restrictions
- Suburban Estates subsidized reserve fencing on boundary

Note: Suburban Estates has a land covenant requiring 1.0m setback on all road frontages, this will be attached to all titles. CCC rules are part of the current operative district plan.

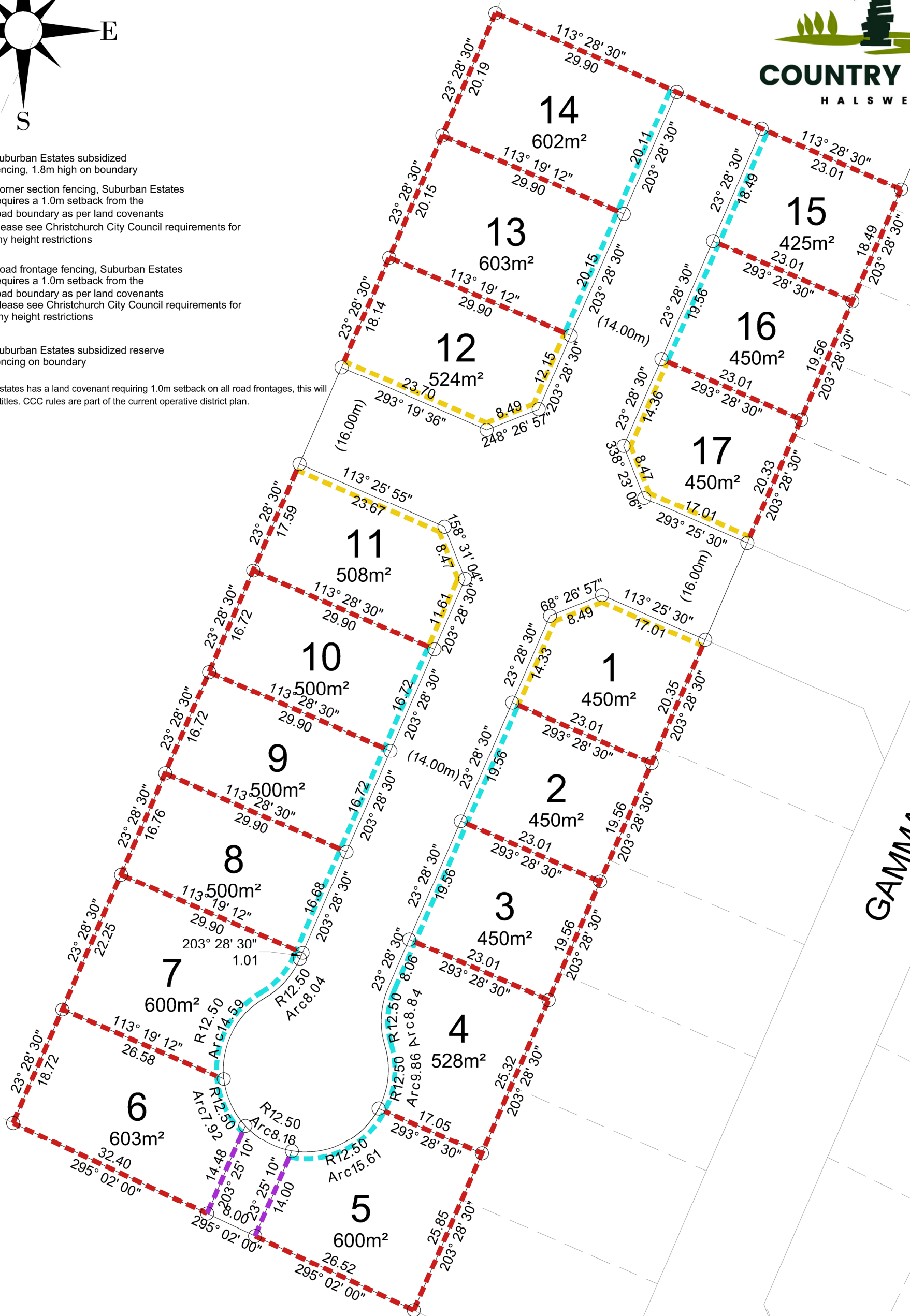

All dimensions and areas are subject to final legal survey

COUNTRY PALMS 3RD RELEASE - DIMENSION PLAN

Date 24/04/2020